

# Wild Earth Travel

*Small Ships, Big Adventures*

**wildearth-travel.com**

**info@wildearth-travel.com**

## GALAPAGOS 5 DAY CRUISE ABOARD ALYA LUXURY CATAMARAN

A 5 Day cruise exploring the heart of the Galapagos islands.

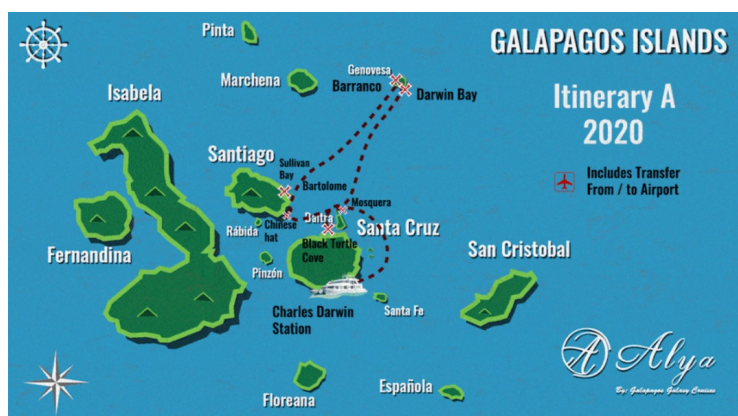

### ITINERARY

#### Day 1 BALTRA AIRPORT – BLACK TURTLE COVE

Baltra airport. Reception at airport. Transfer in. Welcome on board Alya Catamaran. Welcome drink. Lunch. **BLACK TURTLE COVE:** After lunch our first visit is to Black Turtle Cove which is situated in the northern region of Santa Cruz. This bay is surrounded by mangroves and is accessible only by dinghy only. The shallow cove is a safe refuge for marine life. Black-tip reef sharks, marine turtles, and a variety of rays are often spotted here. Return to Alya. Dinner.

#### Day 2 GENOVESA ISLAND: DARWIN BAY & BARRANCO

**DARWIN BAY:** wet landing, coral beach, activities for this day: short walks, photography, swimming, snorkeling. Genovesa is a small island in the north of the Galapagos. Our unloading in Darwin Bay will be wet. Near the beach is a mangrove swamp where we will find a colony of frigates, marine iguanas, red-footed boobies and mask boobies, the great terrestrial finch, seagulls, herons, and cactus finch. Following the land visit, our passengers can enjoy a swim in the bay. Snacks and refreshments are available. Lunch. **BARRANCO:** dry landing, activities: hiking. Also known as Prince Phillip's stairs. Here, we

Wild Earth Travel

*Small Ships, Big Adventures*

**0800 945 3327** (within New Zealand) | +64 (0) 3 365 1355 | **1800 107 715** (within Australia)

info@wildearth-travel.com | **wildearth-travel.com**



# Wild Earth Travel

*Small Ships, Big Adventures*

**wildearth-travel.com**

**info@wildearth-travel.com**

will go for a walk on the Barranco path. On our journey we will observe tropical birds, petrels, common frigate, red-foot boobies, mask boobies, doves, and finches. Dinner.

## Day 3 SANTIAGO ISLAND: SULLIVAN BAY & BARTOLOME ISLAND

SANTIAGO ISLAND: SULLIVAN BAY: wet landing and hiking. Description: Virtually uneroded lava flows cover an extensive area of this island. Lava pahoe-hoe (basaltic lava that has a smooth, billowy, undulating or ropy surface), hornitos, and mollugo (a lava colonizer) can be seen. Snacks and refreshing beverages await you on board the ship. Lunch. BARTOLOME ISLAND: dry landing, wet landing for the beach. Activities on this island include: walking, swimming, snorkeling, and photography. We will follow a path to the top (114m) where we can see pioneering plants such as tiqulia, chamaesyce, and scalesia. The island has been formed by cones, lava pipes where lava once flowed. Following the wet landing at the beach, we will follow a path through mangrove swamps and sand dune vegetation, to the south beach. At the north beach, guests can enjoy swimming and snorkeling. From the top of Bartolome, we will be able to see the islands of Santiago, Rabida, and Isabela. We will see penguins in the Rock Pinnacle. Dinner.

## Day 4 DRAGON HILL – SANTA CRUZ ISLAND: CHINESE HAT

CHINESE HAT: A small islet located near the south-east coast of Santiago. It's shaped like a Chinese hat when seen from afar. It is an island consisting of a cone type "Splatter" (lava ejected as drops which fall close to where they came from, which form an inclined cone) that forms the summit and many lava tubes that go down to the coast. On the west side you can see pillow-type lava formations, which are an indicator that the flows were formed under the sea and have been raised upward, which is why coral heads are found on the lava. This visit provides an excellent opportunity for the interpretation of geological features such as lava tubes and lava flows. The trail is 700 m (round trip) and the minimum time it takes for this trek is 30 minutes. Return Alya. Lunch MOSQUERA: This islet is located between Baltra Island and North Seymour. Here, we find the biggest sea lion colony; it is also possible to observe several species of birds. Enjoy the white sand beach. Return Alya. Dinner

## Day 5 SANTA CRUZ ISLAND: CHARLES DARWIN STATION – AIRPORT

After breakfast, we will visit Charles Darwin Station which is located in the main port on Santa Cruz Island; we will take a private bus to the entrance of the breeding center where we will see tortoises and land iguanas in captivity. This center is the main breeding site on the islands. Animals that were in danger of extinction on the various islands are maintained in captivity. Thanks to the dedicated work of several institutions, some species are being saved. Here lived Lonesome George, the famous last survivor of the giant tortoise species found on Pinta Island. Transfer to the airport.

### Please Note

This itinerary is subject to change without notice; due to seasonal changes, weather conditions or Galapagos National Park regulations.

**Wild Earth Travel**

*Small Ships, Big Adventures*

**0800 945 3327** (within New Zealand) | +64 (0) 3 365 1355 | **1800 107 715** (within Australia)

info@wildearth-travel.com | wildearth-travel.com



# Wild Earth Travel

*Small Ships, Big Adventures*

**wildearth-travel.com**

**info@wildearth-travel.com**

## YOUR SHIP: ALYA

<b>YOUR SHIP:</b>	<b>Alya</b>
<b>VESSEL TYPE:</b>	<b>Catamaran</b>
<b>LENGTH:</b>	<b>31.5 metres</b>
<b>PASSENGER CAPACITY:</b>	<b>16</b>
<b>BUILT/REFURBISHED:</b>	<b>2017</b>

Alya Catamaran is a Luxury cruise ship, built in Guayaquil in 2017. It has 2 life rafts, 2 Zodiacs and it has communication with the Galapagos, the Galagents office and the Ecuadorian Marine Service. Alya Luxury Catamaran offers: 9 comfortable cabins, eight of them have private balconies. The beds in the cabins can be king or twin. - There are many social areas for your comfort and relaxation. - Enjoy a drink from one of the catamaran's two bars. - The nine crew members and bilingual guide provide for a safe and informative trip in the Galapagos Islands. - Certified bilingual naturalist guide - Snorkel equipment provided and wetsuit rental available. - Safety equipment (35 life jackets - 4 lifebuoys 9mm - Flare light, smoke signals, flashlights with SOS signals and other types of visual signals. - 2 survival rafts, 25 passengers each. - Fire extinguishers 10 lb and 2lb. - Fire hoses 15m. - Fire detectors and complete fire protection system.)

### Upper Deck

4 Cabins 172ft<sup>2</sup> / 16m<sup>2</sup> double cabins (all with private balcony & bathroom) - Bridge - Captain's Cabin - Bar

### Main Deck

5 cabins, One 205ft<sup>2</sup> / 19m<sup>2</sup> double cabin. Four 215ft<sup>2</sup> / 20m<sup>2</sup>

double cabins with private balcony. - Guide's cabin - Boutique - Porch - Dining room 27.58m<sup>2</sup> - Living room 27.58m<sup>2</sup> - Wine storage - Bar - Coffee station

### Lower Deck

2 Machine Rooms - Crew Dining - 4 Crew Cabins & 1 Double Crew Cabin - Laundry - Cruise Manager

### Bar and Restaurant

Tasting the food on board the Alya Luxury Catamaran is a unique experience. The mixture of national and international dishes will surprise you. While on board, you can enjoy a cup of coffee, or cappuccino if you prefer. Our coffee machine is available to you during the day. If you prefer something stronger, you can choose from an assortment of cocktails or beer. We offer a variety of dishes, enough to satisfy the appetite of any guest, and we have a little more for those who want a second helping. If our guests have special dietary needs, such as: lactose intolerance, gluten-free, allergies, vegetarian, etc., we can accommodate their needs. However, keep in mind that we need to know about such needs in advance. Our buffet breakfast includes a variety of sausages; cheese and bread are available. On our buffet lunch, you will find accompaniments, along with hot and cold salads. Dinner is a served meal with two options to choose from. Juice or water will be included at each meal.

### Social Area

While you are sailing through the Galapagos Islands we have comfortable areas for your enjoyment. Have a good time with your family and meet new friends in the lounge and bar. In the dining room area we serve the most delicious food on the seas cooked by our professional chefs. You can also enjoy your food



Wild Earth Travel  
*Small Ships, Big Adventures*

**0800 945 3327** (within New Zealand) | +64 (0) 3 365 1355 | **1800 107 715** (within Australia)

info@wildearth-travel.com | **wildearth-travel.com**

# Wild Earth Travel

*Small Ships, Big Adventures*

**wildearth-travel.com**

**info@wildearth-travel.com**

in the alfresco area; it's a great idea to eat with the ocean view. On the sundeck area we have spacious sofas where you can enjoy the best views and sunsets of your life. Relax in the Jacuzzi while you have some drinks or simply take a rest.

## Activities

Having entertainment in the Galapagos is important! We have available four double kayaks, two zodiacs for panga rides, and snorkeling equipment. Wetsuits are available for rent. Our complete itineraries are developed for the benefit of our passengers, who will have the opportunity to combine hiking, snorkeling, beach time, swimming, photography, kayaking and animal watching in their natural habitat. Our professional guides will introduce you to the most relevant sites on each island. If you want to do some extra activities while you are enjoying your cruise, such as diving, artisanal fishing, and more, we will be glad to organize something special for you.



al for you.

Wild Earth Travel

*Small Ships, Big Adventures*

**0800 945 3327** (within New Zealand) | +64 (0) 3 365 1355 | **1800 107 715** (within Australia)

info@wildearth-travel.com | **wildearth-travel.com**

# Wild Earth Travel

*Small Ships, Big Adventures*

[wildearth-travel.com](http://wildearth-travel.com)

[info@wildearth-travel.com](mailto:info@wildearth-travel.com)

## INSIDE YOUR SHIP

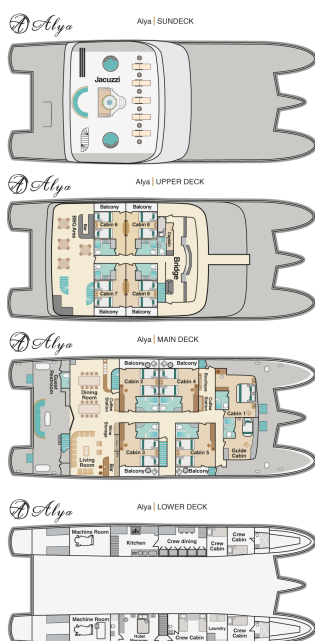

Cabin



# Wild Earth Travel

*Small Ships, Big Adventures*

[wildearth-travel.com](http://wildearth-travel.com)

[info@wildearth-travel.com](mailto:info@wildearth-travel.com)

## PRICING

**24-Apr-2025 to 28-Apr-2025**

Cabin	4000 USD pp
-------	-------------

**08-May-2025 to 12-May-2025**

Cabin	4000 USD pp
-------	-------------

**22-May-2025 to 26-May-2025**

Cabin	4000 USD pp
-------	-------------

**05-Jun-2025 to 09-Jun-2025**

Cabin	4000 USD pp
-------	-------------

**19-Jun-2025 to 23-Jun-2025**

Cabin	4000 USD pp
-------	-------------

**03-Jul-2025 to 07-Jul-2025**

Cabin	4000 USD pp
-------	-------------

**17-Jul-2025 to 21-Jul-2025**

Cabin	4000 USD pp
-------	-------------

**31-Jul-2025 to 04-Aug-2025**

Cabin	4000 USD pp
-------	-------------

**14-Aug-2025 to 18-Aug-2025**

Cabin	4000 USD pp
-------	-------------

**28-Aug-2025 to 01-Sep-2025**

Cabin	4000 USD pp
-------	-------------

**11-Sep-2025 to 15-Sep-2025**

Cabin	4000 USD pp
-------	-------------

**25-Sep-2025 to 29-Sep-2025**

Cabin	4000 USD pp
-------	-------------

**09-Oct-2025 to 13-Oct-2025**

Cabin	4000 USD pp
-------	-------------

**23-Oct-2025 to 27-Oct-2025**

Cabin	4000 USD pp
-------	-------------

**06-Nov-2025 to 10-Nov-2025**

Cabin	4000 USD pp
-------	-------------

**20-Nov-2025 to 24-Nov-2025**

Cabin	4000 USD pp
-------	-------------

**01-Jan-2026 to 05-Jan-2026**

Cabin	4600 USD pp
-------	-------------

**15-Jan-2026 to 19-Jan-2026**

Cabin	4600 USD pp
-------	-------------

**29-Jan-2026 to 02-Feb-2026**

Cabin	4600 USD pp
-------	-------------

**12-Feb-2026 to 16-Feb-2026**

Cabin	4600 USD pp
-------	-------------

**26-Feb-2026 to 02-Mar-2026**

Cabin	4600 USD pp
-------	-------------

**12-Mar-2026 to 16-Mar-2026**

Cabin	4600 USD pp
-------	-------------

Wild Earth Travel  
*Small Ships, Big Adventures*

**0800 945 3327** (within New Zealand) | +64 (0) 3 365 1355 | **1800 107 715** (within Australia)

[info@wildearth-travel.com](mailto:info@wildearth-travel.com) | [wildearth-travel.com](http://wildearth-travel.com)

# Wild Earth Travel

*Small Ships, Big Adventures*

**wildearth-travel.com**

**info@wildearth-travel.com**

**26-Mar-2026 to 30-Mar-2026**

Cabin	4600 USD pp
-------	-------------

**10-Sep-2026 to 14-Sep-2026**

Cabin	4600 USD pp
-------	-------------

**09-Apr-2026 to 13-Apr-2026**

Cabin	4600 USD pp
-------	-------------

**24-Sep-2026 to 28-Sep-2026**

Cabin	4600 USD pp
-------	-------------

**23-Apr-2026 to 27-Apr-2026**

Cabin	4600 USD pp
-------	-------------

**07-May-2026 to 11-May-2026**

Cabin	4600 USD pp
-------	-------------

**21-May-2026 to 25-May-2026**

Cabin	4600 USD pp
-------	-------------

**04-Jun-2026 to 08-Jun-2026**

Cabin	4600 USD pp
-------	-------------

**18-Jun-2026 to 22-Jun-2026**

Cabin	4600 USD pp
-------	-------------

**02-Jul-2026 to 06-Jul-2026**

Cabin	4600 USD pp
-------	-------------

**16-Jul-2026 to 20-Jul-2026**

Cabin	4600 USD pp
-------	-------------

**30-Jul-2026 to 03-Aug-2026**

Cabin	4600 USD pp
-------	-------------

**13-Aug-2026 to 17-Aug-2026**

Cabin	4600 USD pp
-------	-------------

**27-Aug-2026 to 31-Aug-2026**

Cabin	4600 USD pp
-------	-------------

**Wild Earth Travel**  
*Small Ships, Big Adventures*

**0800 945 3327** (within New Zealand) | +64 (0) 3 365 1355 | **1800 107 715** (within Australia)

info@wildearth-travel.com | wildearth-travel.com



# Wild Earth Travel

*Small Ships, Big Adventures*

**wildearth-travel.com**

**info@wildearth-travel.com**

## PRICING

**08-Oct-2026 to 12-Oct-2026**

Cabin	4600 USD pp
-------	-------------

**22-Oct-2026 to 26-Oct-2026**

Cabin	4600 USD pp
-------	-------------

**05-Nov-2026 to 09-Nov-2026**

Cabin	4600 USD pp
-------	-------------

**19-Nov-2026 to 23-Nov-2026**

Cabin	4600 USD pp
-------	-------------

**03-Dec-2026 to 07-Dec-2026**

Cabin	4600 USD pp
-------	-------------

**17-Dec-2026 to 21-Dec-2026**

Cabin	4600 USD pp
-------	-------------

**31-Dec-2026 to 04-Jan-2027**

Cabin	4600 USD pp
-------	-------------

Galapagos National Park Entrance  
Fee, Galapagos Transit card 220  
USD pp

**ADDITIONAL CHARGES:**

Wild Earth Travel  
*Small Ships, Big Adventures*

**0800 945 3327** (within New Zealand) | +64 (0) 3 365 1355 | **1800 107 715** (within Australia)

info@wildearth-travel.com | wildearth-travel.com