

Wild Earth Travel

Small Ships, Big Adventures

wildearth-travel.com

info@wildearth-travel.com

GALAPAGOS 6 DAY CRUISE C ABOARD ALYA LUXURY CATAMARAN

A 6 day cruise around the south and eastern islands of the the Galapagos. Stopping to Explore Cristobal, Espanola and Floreana. Leaving and returning to Santa Cruz



ITINERARY

Day 1 SEYMOUR

Baltra airport. Reception at airport. Transfer in. Welcome on board Alya Catamaran. Welcome drink. Lunch SEYMOUR: dry landing. Seymour was formed by the lifting of volcanic marine lava. Marine fossils dating back to the Pleistocene period were found on this island. In 1932, Captain Alan Hancock and his crew took 72 malnourished land iguanas from Baltra Island to North Seymour Island so that the iguanas could live in better conditions. In 1934, colonists verified that the iguanas were in good condition. The vegetation of North Seymour is bushy and is host to nesting Real Frigates of the Galapagos. Return to Alya. Dinner.

Day 2 SOUTH PLAZAS, SANTA FE.

SOUTH PLAZAS: are two small islands, created by an uplifting of the land. The land iguanas are smaller here; they nest during the warm season. The hike goes along an extraordinary cliff where sea birds nest. There are approximately 1000 sea lions (*Zalophus Wollebaeki*) located on the south side of the Plazas. SANTA FE: Wet landing, activities for this day: hiking, swimming and snorkeling. With 24 km² and 60 m of height above sea level, this central

Wild Earth Travel

Small Ships, Big Adventures

0800 945 3327 (within New Zealand) | +64 (0) 3 365 1355 | **1800 107 715** (within Australia)

info@wildearth-travel.com | **wildearth-travel.com**



Wild Earth Travel

Small Ships, Big Adventures

wildearth-travel.com

info@wildearth-travel.com

island is a unique place to visit. It has an incredible bay of turquoise water, protected by a natural barrier of rocks. You will see colonies of seals as hawks fly overhead. This island is home to one of the two species of land iguanas found in the Galapagos. Their main food source is the leaves and fruit of the large, thick cactus found here. Crabs, nocturnal herons, marine iguanas, cucuvas and land doves are seen frequently. The Bay is excellent place to swim and to do snorkel. Marine tortoises, rays, sea lions and tropical fish are an amazing attraction! Snacks and refreshing beverages are waiting for you on board. Dinner.

Day 3 SAN CRISTOBAL ISLAND: INTERPRETATION CENTER / KICKED ROCK

INTERPRETATION CENTER: Dry landing. This center is location in the main port. After breakfast, our first visit is to the Interpretation Center of San Cristobal. This modern and sophisticated architectural space was designed for the natural interpretation of the Galapagos. You will learn about the volcanic formation of the islands, the evolution of the species, the history of human settlement, and complex systems and management models. Return Alya Lunch LOBOS ISLANDS: Panga Riding, swimming and snorkeling. Here, we can walk, swim and snorkel among the seals, frigates, marine iguanas, lava lizards, and the small endemic Galapagos snake. Here, we can swim and snorkeling in the same place it. Return Alya Dinner

Day 4 ESPAÑOLA: GARDNER BAY, SUAREZ POINT

GARDNER BAY: wet landing, activities for this visit: short walk, swimming, snorkeling, and observation of seal colony. The sea lion is one of the animals in Galapagos which gets the total attention of the visitors in the Galapagos: they are curious and playful, but at times aggressive; they are nice and loving, but also lazy. In Gardner Bay, we are going to find many of them relaxing on the beach enjoying the sun. In addition to observing these fascinating animals, while snorkeling, we will be able to swim with sea lions, sea turtles, a diversity of tropical fish, marine iguanas, etc. Return Alya Dinner. SUAREZ POINT: Dry landing. Activities: Walking, sight-seeing. We recommend sports shoes, hat or cap, and sunscreen. There is no color more amazing and outstanding in this tropical desert island, than that of the blue-foot boobies. These birds have an impressive form of "greeting" and it is a real thrill to see their mating dance. The blue-footed booby can be seen on several of the islands as nesting grounds and feed are located in several coastal locations. The albatross, an aristocratic bird weighing up to four kilograms, can be observed here. One of

the largest birds of the islands, approximately 12,000 couples nest on Espanola Island and a smaller number nest on Silver Island, near mainland Ecuador. This species is considered endemic to this island; during our walk, we will observe these fantastic birds while taking in the beautiful landscapes offered by this island. It is important to note that albatrosses will not be seen between January and March (non-breeding) season. We will also see colonies of marine iguanas, zayapas, masked boobies, finches, Espanola cucuvas, and seagulls unique to the islands. Our walk will be on lava rock where we will be able to see lava tubes. Red mangroves are found here. Delicious snacks and fresh beverages are waiting for you on the ship. Dinner

Day 5 FLOREANA: CORMORANT POINT, CERRO ALIERI.

CORMORANT POINT: wet landing, snorkeling and short trekking. This point is located at west of Floreana Island and it is famous for its dark green beach (due to the great quantity of olivine crystals). You can see many marine invertebrates, as well as sea lions, sea iguanas, the frigates and pelicans. Second visit: DEVIL'S CROWN: Activities in this place: panga ride and optional swimming. Enjoy a panga ride around a small island, a satellite islet of Floreana Island. Here, we will find a group of rocks that resemble a Crown due to the constant erosion caused by the sea. It is one of the better places to snorkel (shallow diving) in the interior and around the crown. Excellent visibility allows guests to admire a great variety of fish and sea animals. Return Alya Lunch CERRO ALIERI: is located east of Port Velasco Ibarra. Hiking. This place may be muddy and it may rain. Wear appropriate clothing and footwear for this type of weather. There are trees and shrubs characteristic of the place, the 56% of vegetation is native such as: Lippia salicifolia, Linum cratericola, Lecocarpus pinnatifidus, Scalesia Pedunculata. In this place there are a plant that is critically endangered: The Catericola Linum there are 40 individuals found. Return Alya. Dinner.

Day 6 SANTA CRUZ: HIGHLANDS

Where we have a trekking and we will find the giant tortoises in their natural habitat, this is a natural spectacular. For this visit, we recommend good walking shoes, long pants, a raincoat, a hat, and sunblock. Transfer Out.

Please Note

This itinerary is subject to change without notice; due to seasonal changes,

Wild Earth Travel

Small Ships, Big Adventures

0800 945 3327 (within New Zealand) | +64 (0) 3 365 1355 | **1800 107 715** (within Australia)

info@wildearth-travel.com | wildearth-travel.com



Wild Earth Travel

Small Ships, Big Adventures



wildearth-travel.com

info@wildearth-travel.com

weather conditions or Galapagos National Park regulations.

Wild Earth Travel
Small Ships, Big Adventures

0800 945 3327 (within New Zealand) | +64 (0) 3 365 1355 | **1800 107 715** (within Australia)

info@wildearth-travel.com | **wildearth-travel.com**



Wild Earth Travel

Small Ships, Big Adventures

wildearth-travel.com

info@wildearth-travel.com

YOUR SHIP: ALYA

YOUR SHIP:	Alya
VESSEL TYPE:	Catamaran
LENGTH:	31.5 metres
PASSENGER CAPACITY:	16
BUILT/REFURBISHED:	2017

Alya Catamaran is a Luxury cruise ship, built in Guayaquil in 2017. It has 2 life rafts, 2 Zodiacs and it has communication with the Galapagos, the Galagents office and the Ecuadorian Marine Service. Alya Luxury Catamaran offers: 9 comfortable cabins, eight of them have private balconies. The beds in the cabins can be king or twin. - There are many social areas for your comfort and relaxation. - Enjoy a drink from one of the catamaran's two bars. - The nine crew members and bilingual guide provide for a safe and informative trip in the Galapagos Islands. - Certified bilingual naturalist guide - Snorkel equipment provided and wetsuit rental available. - Safety equipment (35 life jackets - 4 lifebuoys 9mm - Flare light, smoke signals, flashlights with SOS signals and other types of visual signals. - 2 survival rafts, 25 passengers each. - Fire extinguishers 10 lb and 2lb. - Fire hoses 15m. - Fire detectors and complete fire protection system.)

Upper Deck

4 Cabins 172ft² / 16m² double cabins (all with private balcony & bathroom) - Bridge - Captain's Cabin - Bar

Main Deck

5 cabins, One 205ft² / 19m² double cabin. Four 215ft² / 20m²

double cabins with private balcony. - Guide's cabin - Boutique - Porch - Dining room 27.58m² - Living room 27.58m² - Wine storage - Bar - Coffee station

Lower Deck

2 Machine Rooms - Crew Dining - 4 Crew Cabins & 1 Double Crew Cabin - Laundry - Cruise Manager

Bar and Restaurant

Tasting the food on board the Alya Luxury Catamaran is a unique experience. The mixture of national and international dishes will surprise you. While on board, you can enjoy a cup of coffee, or cappuccino if you prefer. Our coffee machine is available to you during the day. If you prefer something stronger, you can choose from an assortment of cocktails or beer. We offer a variety of dishes, enough to satisfy the appetite of any guest, and we have a little more for those who want a second helping. If our guests have special dietary needs, such as: lactose intolerance, gluten-free, allergies, vegetarian, etc., we can accommodate their needs. However, keep in mind that we need to know about such needs in advance. Our buffet breakfast includes a variety of sausages; cheese and bread are available. On our buffet lunch, you will find accompaniments, along with hot and cold salads. Dinner is a served meal with two options to choose from. Juice or water will be included at each meal.

Social Area

While you are sailing through the Galapagos Islands we have comfortable areas for your enjoyment. Have a good time with your family and meet new friends in the lounge and bar. In the dining room area we serve the most delicious food on the seas cooked by our professional chefs. You can also enjoy your food



Wild Earth Travel
Small Ships, Big Adventures

0800 945 3327 (within New Zealand) | +64 (0) 3 365 1355 | **1800 107 715** (within Australia)

info@wildearth-travel.com | **wildearth-travel.com**

Wild Earth Travel

Small Ships, Big Adventures

wildearth-travel.com

info@wildearth-travel.com

in the alfresco area; it's a great idea to eat with the ocean view. On the sundeck area we have spacious sofas where you can enjoy the best views and sunsets of your life. Relax in the Jacuzzi while you have some drinks or simply take a rest.

Activities

Having entertainment in the Galapagos is important! We have available four double kayaks, two zodiacs for panga rides, and snorkeling equipment. Wetsuits are available for rent. Our complete itineraries are developed for the benefit of our passengers, who will have the opportunity to combine hiking, snorkeling, beach time, swimming, photography, kayaking and animal watching in their natural habitat. Our professional guides will introduce you to the most relevant sites on each island. If you want to do some extra activities while you are enjoying your cruise, such as diving, artisanal fishing, and more, we will be glad to organize something special for you.



al for you.

Wild Earth Travel

Small Ships, Big Adventures

0800 945 3327 (within New Zealand) | +64 (0) 3 365 1355 | **1800 107 715** (within Australia)

info@wildearth-travel.com | **wildearth-travel.com**

Wild Earth Travel

Small Ships, Big Adventures

wildearth-travel.com

info@wildearth-travel.com

INSIDE YOUR SHIP

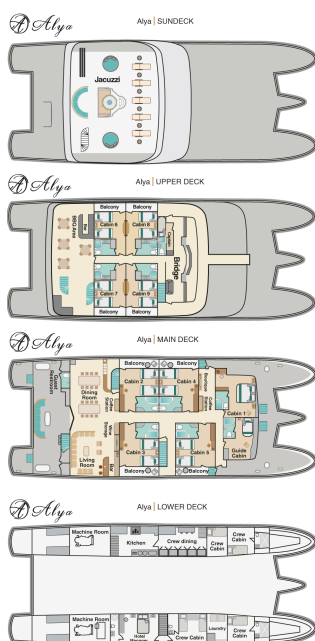

Cabin



Wild Earth Travel

Small Ships, Big Adventures

wildearth-travel.com

info@wildearth-travel.com

PRICING

03-May-2025 to 08-May-2025

Cabin	5000 USD pp
-------	-------------

17-May-2025 to 22-May-2025

Cabin	5000 USD pp
-------	-------------

31-May-2025 to 05-Jun-2025

Cabin	5000 USD pp
-------	-------------

14-Jun-2025 to 19-Jun-2025

Cabin	5000 USD pp
-------	-------------

28-Jun-2025 to 03-Jul-2025

Cabin	5000 USD pp
-------	-------------

12-Jul-2025 to 17-Jul-2025

Cabin	5000 USD pp
-------	-------------

26-Jul-2025 to 31-Jul-2025

Cabin	5000 USD pp
-------	-------------

09-Aug-2025 to 14-Aug-2025

Cabin	5000 USD pp
-------	-------------

23-Aug-2025 to 28-Aug-2025

Cabin	5000 USD pp
-------	-------------

06-Sep-2025 to 11-Sep-2025

Cabin	5000 USD pp
-------	-------------

20-Sep-2025 to 25-Sep-2025

Cabin	5000 USD pp
-------	-------------

04-Oct-2025 to 09-Oct-2025

Cabin	5000 USD pp
-------	-------------

18-Oct-2025 to 23-Oct-2025

Cabin	5000 USD pp
-------	-------------

01-Nov-2025 to 06-Nov-2025

Cabin	5000 USD pp
-------	-------------

15-Nov-2025 to 20-Nov-2025

Cabin	5000 USD pp
-------	-------------

29-Nov-2025 to 04-Dec-2025

Cabin	5000 USD pp
-------	-------------

13-Dec-2025 to 18-Dec-2025

Cabin	5000 USD pp
-------	-------------

27-Dec-2025 to 01-Jan-2026

Cabin	7500 USD pp
-------	-------------

10-Jan-2026 to 15-Jan-2026

Cabin	5700 USD pp
-------	-------------

24-Jan-2026 to 29-Jan-2026

Cabin	5700 USD pp
-------	-------------

07-Feb-2026 to 12-Feb-2026

Cabin	5700 USD pp
-------	-------------

21-Feb-2026 to 26-Feb-2026

Cabin	5700 USD pp
-------	-------------

Wild Earth Travel
Small Ships, Big Adventures

0800 945 3327 (within New Zealand) | +64 (0) 3 365 1355 | **1800 107 715** (within Australia)

info@wildearth-travel.com | wildearth-travel.com

Wild Earth Travel

Small Ships, Big Adventures

wildearth-travel.com

info@wildearth-travel.com

07-Mar-2026 to 12-Mar-2026

Cabin	5700 USD pp
-------	-------------

05-Sep-2026 to 10-Sep-2026

Cabin	5700 USD pp
-------	-------------

21-Mar-2026 to 26-Mar-2026

Cabin	5700 USD pp
-------	-------------

19-Sep-2026 to 24-Sep-2026

Cabin	5700 USD pp
-------	-------------

04-Apr-2026 to 09-Apr-2026

Cabin	5700 USD pp
-------	-------------

18-Apr-2026 to 23-Apr-2026

Cabin	5700 USD pp
-------	-------------

02-May-2026 to 07-May-2026

Cabin	5700 USD pp
-------	-------------

30-May-2026 to 04-Jun-2026

Cabin	5700 USD pp
-------	-------------

13-Jun-2026 to 18-Jun-2026

Cabin	5700 USD pp
-------	-------------

27-Jun-2026 to 02-Jul-2026

Cabin	5700 USD pp
-------	-------------

11-Jul-2026 to 16-Jul-2026

Cabin	5700 USD pp
-------	-------------

25-Jul-2026 to 30-Jul-2026

Cabin	5700 USD pp
-------	-------------

08-Aug-2026 to 13-Aug-2026

Cabin	5700 USD pp
-------	-------------

22-Aug-2026 to 27-Aug-2026

Cabin	5700 USD pp
-------	-------------

Wild Earth Travel
Small Ships, Big Adventures

0800 945 3327 (within New Zealand) | +64 (0) 3 365 1355 | **1800 107 715** (within Australia)

info@wildearth-travel.com | wildearth-travel.com



Wild Earth Travel

Small Ships, Big Adventures

wildearth-travel.com

info@wildearth-travel.com

PRICING

03-Oct-2026 to 08-Oct-2026

Cabin	5700 USD pp
-------	-------------

17-Oct-2026 to 22-Oct-2026

Cabin	5700 USD pp
-------	-------------

31-Oct-2026 to 05-Nov-2026

Cabin	5700 USD pp
-------	-------------

14-Nov-2026 to 19-Nov-2026

Cabin	5700 USD pp
-------	-------------

28-Nov-2026 to 03-Dec-2026

Cabin	5700 USD pp
-------	-------------

12-Dec-2026 to 17-Dec-2026

Cabin	5700 USD pp
-------	-------------

26-Dec-2026 to 31-Dec-2026

Cabin	8550 USD pp
-------	-------------

Galapagos National Park Entrance

Fee, Galapagos Transit card 220

USD pp

ADDITIONAL CHARGES:



Wild Earth Travel

Small Ships, Big Adventures

0800 945 3327 (within New Zealand) | +64 (0) 3 365 1355 | **1800 107 715** (within Australia)

info@wildearth-travel.com | **wildearth-travel.com**