



## GREAT BEAR RAINFOREST - NORTH AMERICAN SAFARI IN THE FALL

### The Ancient North American Rainforest

Explore the wild and remote regions of the central coast of British Columbia on a Great Bear Rainforest tour in the Autumn. The fall months bring the return of the salmon and with it a feeding frenzy to be witnessed. Whales, marine mammals, marine birds, bears and more all gather in this region to feast on the bountiful salmon that have returned to spawn in the rivers. This is the best chance to witness the rare spirit bear at a salmon stream or see a mother grizzly teach her cub how to catch a salmon in a major river estuary.

Great Bear Rainforest tours set out to explore fjordlands, remote islands, river estuaries, and west coast beaches. Get to know the intricate and complex temperate rainforest and the species that thrive here, with expert guides and an informative naturalist whose knowledge of the natural history will be shared with you.

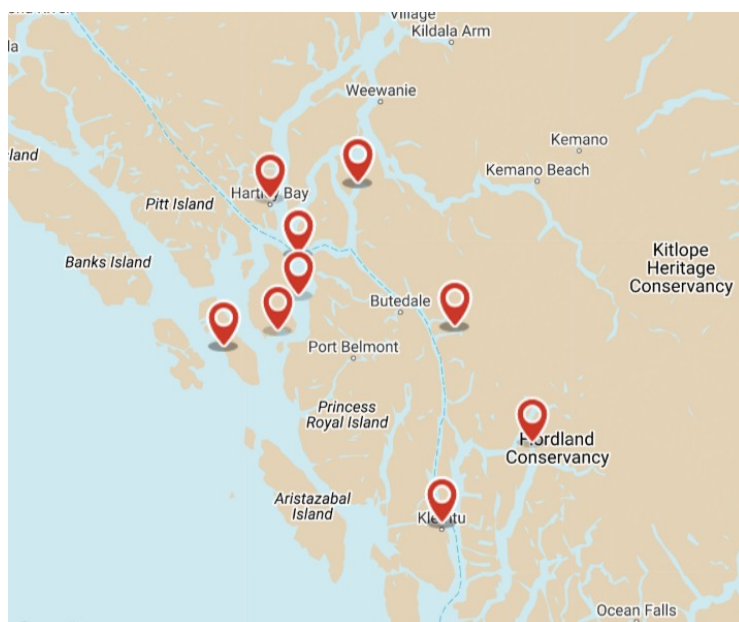

### ITINERARY

#### Days 1-3 Haisla Territory

Day 1: Welcome aboard in Haisla territory, cruising to evening anchorage, watching for whales. Evening rainforest walk before dinner.

Day 2: Crossing into Hennaksiala territory, with traditions and stories of our mentor, Killer Whale Clan elder Wa'xaid (Cecil Paul). Cruising down a spectacular fjord, where granite mountains rise from thousands of feet below the sea. Viewing waterfalls and possible mountain goats. Exploring estuary meadows, where grizzly bears spend their days in the autumn. Optional evening kayaking.

Day 3: Grizzly bear viewing among the fjords. Learning the Indigenous history



and stories of special sites in the region. Cruising the Great Bear's island channels.

#### Days 4-6 Whale Channel Region

Day 4: Visit island known as the epicentre of spirit bears with our Gitga'at friends and guides. Full day at viewing site for the best opportunity to view a spirit bear.

Day 5: Morning shore exploration in estuary. Cruising Whale Channel region, a critical habitat for several species of whales. Marine mammal viewing. Visit whale researchers at remote station. Island anchorage.

Day 6: Visit the Great Bear Rainforest's wild outer islands and beaches, with hike to views. Kayaking, possible wolf sighting. Cruising to and exploring archipelago of tiny islands, some areas so wild they're not yet charted. Seabird viewing.

#### Days 7-8 Spirit Bear Island

Day 7: Cruising inner channels. Rainforest shore trip. Visit natural hot springs for a soak. Last night dinner in natural anchorage.

Day 8: Cruising to port, watching for wildlife.

#### Please note:

Itineraries are subject to change.



[wildearth-travel.com](http://wildearth-travel.com)

[info@wildearth-travel.com](mailto:info@wildearth-travel.com)

## YOUR SHIP: CASCADIA

<b>YOUR SHIP:</b>	<b>Cascadia</b>
<b>VESSEL TYPE:</b>	<b>Catamaran</b>
<b>LENGTH:</b>	<b>138 ft / 42 m</b>
<b>PASSENGER CAPACITY:</b>	<b>24</b>
<b>BUILT/REFURBISHED:</b>	<b>2007/2018/2019</b>

Cascadia is a go-anywhere, expedition style catamaran. She accommodates up to 24 guests in 12 luxurious cabins, with a crew of 10. She is unlike any other vessel offering expeditions on the British Columbia coast, having been built specifically for high-quality, boutique cruises. Light, spacious and comfortable, she is also capable of reaching the wildest, most naturally rich places on the coast. Her small size and guest numbers provide an authentic, human-scale experience that respects the carrying capacity of coastal inlets and communities.

**Ship And Accommodations** Find comfort and solitude in your private cabin or enjoy time in any of the interior or outdoor lounges, or the "open" bridge. Cascadia's large windows bring the outside in, and her separate dining area becomes a sophisticated "long table" event for meals. Her decks are wide and welcoming, with seating areas on different levels.

**Salon** Large windows surround the salon making it a perfect place to look for whales while staying protected, chat with other guests while lounging on our comfortable sofas, or enjoy a beverage from the nearby bar.

**Dining Area** Enjoy our chefs' fine west-coast influenced creations while watching the sun go down. Sit and discuss your day's

adventure with your captain, afloat in a remote natural anchorage.

**Terrace Lounge And Dining Area** Dine alfresco on temperate evenings, lounge with your morning coffee, or watch the world go by during the day. This area is the perfect mix of outside and inside.

**Bridge of Cascadia** Cascadia's bridge is open to you. You'll have 180-degree views from here, along with being able to learn about navigation and the vessel systems from our crew. On the port side, you may also enjoy our indoor-outdoor loveseat. You can watch the world go by from behind a protective window, but still have quick access to the fresh air and the deck for whale watching.

**Top Deck & Hot Tub Lounge** on a chaise, soak under the stars, or enjoy the bird's eye view of the ship and the world around her from Cascadia's new top deck.

**Cabins** All cabins have individual climate control, wardrobes and an outside location, with windows for natural light. All have ensembles. All are 'outside' cabins, with windows for natural light. **Kayaks, Shore Boats, Naturalist Tools** Cascadia has 6 double and 2 single kayaks for paddling in coves and bays, as well as two beautiful landing craft style tenders, custom designed for our program. She carries a suite of tools for exploring the natural world, including a hydrophone for listening to whales. Her library contains books on the cultural history and nature of the BC and Alaska coast.





**Wild Earth Travel**  
*Small Ships, Big Adventures*

**wildearth-travel.com**      **info@wildearth-travel.com**



aska coast.

# Wild Earth Travel

*Small Ships, Big Adventures*

[wildearth-travel.com](http://wildearth-travel.com)

[info@wildearth-travel.com](mailto:info@wildearth-travel.com)

## INSIDE YOUR SHIP

TOP DECK

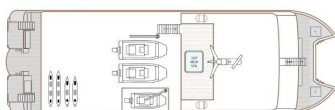

BRIDGE DECK

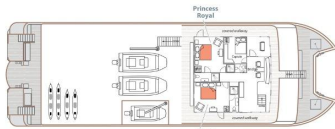

MAIN DECK



LOWER DECK

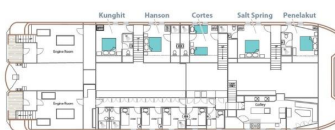

Cabin

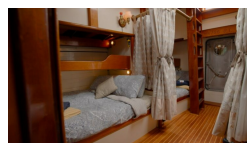

Category 1



Category 2



Category 3





**wildearth-travel.com**

**info@wildearth-travel.com**

## PRICING

### 30-Aug-2026 to 06-Sep-2026

Category 1	12350 CAD pp
Category 2	14350 CAD pp
Category 3	16320 CAD pp

### 01-Sep-2026 to 08-Sep-2026

Cabin	8650 CAD pp
Prince Rupert to Kitimat Cruise	0 pp

### 07-Sep-2026 to 14-Sep-2026

Category 1	12850 CAD pp
Category 2	14890 CAD pp
Category 3	16950 CAD pp
Great Bear Rainforest with Canadian Geographic	0 pp

### 07-Sep-2026 to 14-Sep-2026

Category 1	12850 CAD pp
Category 2	14890 CAD pp
Category 3	16950 CAD pp
Great Bear Rainforest with Canadian Geographic	0 pp

### 16-Sep-2026 to 23-Sep-2026

Category 1	12350 CAD pp
Category 2	14350 CAD pp
Category 3	16320 CAD pp

### 17-Sep-2026 to 24-Sep-2026

Cabin	8650 CAD pp
Bella Bella to Kitimat Cruise	0 pp

### 24-Sep-2026 to 01-Oct-2026

Category 1	12350 CAD pp
Category 2	14350 CAD pp
Category 3	16320 CAD pp

### 26-Sep-2026 to 03-Oct-2026

Cabin	8650 CAD pp
Kitimat to Bella Bella Cruise	0 pp