



# Wild Earth Travel

*Small Ships, Big Adventures*



[wildearth-travel.com](http://wildearth-travel.com)

[info@wildearth-travel.com](mailto:info@wildearth-travel.com)

## THE ANTARCTIC PENINSULA & EXTREME WEDDELL SEA EXPEDITION

Join us for a once in a lifetime expedition voyage to the Weddell Sea and the Seventh Continent. Experience the incredible wildlife of these icy waters, witness stunning mountain scenery and wonder at gigantic icebergs during 12 action-packed days.

Join us onboard our purpose-built, ice-class expedition vessel, Ocean Albatros to experience the majesty and wonder of Earth's last frontier up close and personal. Our vessels enable us to get closer to nature, with a fleet of Zodiac landing craft, a team of experienced expert expedition guides, and the Antarctic Peninsula as our spectacular destination.

Departing Argentina's southernmost city of Ushuaia, we cross the mighty Drake Passage en-route to the South Shetland Islands, aiming to arrive on the afternoon of the third day of our voyage (weather permitting). The unique X-Bow design of our expedition vessels offers exceptional stability at sea, giving you a smoother ride across some of Earth's most challenging waters, while the vessels' speed allows us to maximise our time in Antarctica to offer a superlative exploration experience.

Continuing southward from the South Shetland Islands, we will delve deeper into the inlets and bays of the Antarctic Peninsula, entering the famous Gerlache Strait, where glittering ice cliffs and precipitous peaks rise straight out of the frigid water. Icebergs, glaciers, mountains and rugged snowfields characterise this wildly beautiful alien landscape. From here, we will venture into the Antarctic Sound and the icy Weddell Sea, the vast icebound wilderness which defeated many early

Antarctic expeditions. On no other journey can you experience so much pristine nature and varied wildlife in such a short time.

Our skilled Captain and Expedition Leader will work hard to maximise opportunities to explore the White Continent. While wind, sea and ice conditions will dictate the exact locations we will visit, we will make Zodiac landings to allow guests to set foot on land and experience penguin rookeries, research stations and historical sites, and aim to Zodiac cruise in scenic areas filled with giant icebergs, whales and seals. We always aim to visit locations which showcase the best of Antarctica; while wildlife sighting are of course subject to the whims of Mother Nature, a variety of penguin, whale and seal species can all be found in this inhospitable wilderness. Jaw-dropping scenery and landscapes are guaranteed!

Any voyage to Antarctica is an adventure, but with an average occupancy of 175 guests aboard Ocean Victory and Ocean Albatros, our cruises offer a unique experience for the brave few. Shore landings and Zodiac safaris will occupy our days, while our knowledgeable onboard Expedition Team will offer a selection of specially crafted lectures to inform your matchless expedition experience.

Make sure you reserve your place on this fantastic journey in good time, as we only offer this exciting adventure once per year!



Wild Earth Travel

*Small Ships, Big Adventures*

0800 945 3327 (within New Zealand) | +64 (0) 3 365 1355 | 1800 107 715 (within Australia)

[info@wildearth-travel.com](mailto:info@wildearth-travel.com) | [wildearth-travel.com](http://wildearth-travel.com)

# Wild Earth Travel

*Small Ships, Big Adventures*

[wildearth-travel.com](http://wildearth-travel.com)

[info@wildearth-travel.com](mailto:info@wildearth-travel.com)



e per year!

## ITINERARY

### DAY 1 ARRIVAL IN USHUAIA, EMBARKATION

Arrive in Ushuaia, Argentina - the world's southernmost city. Explore this vibrant Patagonian city, or stretch your legs in the surrounding forests. Alternatively, consider a day trip off the beaten path into the raw nature of Tierra del Fuego. The island of Tierra del Fuego is a hiker's paradise with rugged snow-capped mountains, glaciers, flower-filled meadows and rich boggy wetlands. In the afternoon, we board our vessel, waiting to welcome us in port.

After our mandatory safety drill, our expedition begins as we navigate through

the calm waters of the famous Beagle Channel (named for Charles Darwin's ship). This steep-sided strait divides southern Tierra del Fuego between Chile and Argentina, and has been the jumping-off point for thousands of expeditions into the unknown. Watch out for whales and dolphins as we sail off the edge of the map into the tempestuous Drake Passage.

### DAY 2-3 AT SEA - CROSSING THE DRAKE PASSAGE SOUTHBOUND

As we sail through the renowned Drake Passage, linking Patagonia to the Antarctic Peninsula, brace yourself for its notoriously turbulent waters and fierce westerly winds, aptly called the Roaring Fifties. Thankfully, our purpose-built expedition vessels ensure a comfortable journey, with their uniquely stable X-Bow and powerful engines, guided by an expert crew. Embrace this exciting crossing, considered a badge of honour by seasoned sailors, as you traverse it twice during our expedition.

In the Drake Passage, our focus turns to preparing for our arrival in Antarctica. Your Expedition Leader will provide thorough safety briefings and guidelines to minimise our impact on this pristine environment. Our dedicated Expedition Team will assist in biosecuring your gear while offering tailored lectures on Antarctic exploration, wildlife, and more.

On the third day, we'll cross the Antarctic Convergence, marked by a sudden drop in temperature as warmer currents give way to Antarctic waters. This transition fosters a surge in marine life, promising sightings of petrels, albatrosses, and possibly even penguins, seals, and whales. Weather permitting, we aim to land on the South Shetland Islands on the afternoon of the third day of our expedition, starting our exploration of the Last Continent.

### DAY 4-6 THE ANTARCTIC SOUND AND WEDDELL SEA

In the forthcoming days, our expedition ventures into the captivating region at the northeastern tip of the continent, the Antarctic Sound, gateway to the Weddell Sea. This region is confusingly named after the Swedish vessel Antarctic which first sailed the area in 1902. Despite its northern location, the Antarctic Sound experiences harsh cold conditions due to winds and currents from the Weddell Sea. This area boasts some of Antarctica's most striking scenery, from the vast Adelle Penguin colonies at Hope Bay and Devil's Island,

Wild Earth Travel

*Small Ships, Big Adventures*

0800 945 3327 (within New Zealand) | +64 (0) 3 365 1355 | 1800 107 715 (within Australia)

[info@wildearth-travel.com](mailto:info@wildearth-travel.com) | [wildearth-travel.com](http://wildearth-travel.com)



# Wild Earth Travel

*Small Ships, Big Adventures*



[wildearth-travel.com](http://wildearth-travel.com)

[info@wildearth-travel.com](mailto:info@wildearth-travel.com)

to the dramatic volcanic cliffs at Brown Bluff.

Continuing southward into the Weddell Sea, named after early British Antarctic explorer James Weddell, we encounter immense tabular icebergs and the expansive icepack which nurtures Antarctic krill, the foundation of the food chain. The presence of krill attracts a diverse array of wildlife, including penguins, seals, seabirds, and humpback whales, all of which we hope to see while exploring this icy wilderness.

Navigation through the Weddell Sea presents challenges due to substantial sea ice and massive icebergs. Our experienced Captain and Expedition Leader adapt plans to ensure safe exploration, seizing opportunities to delve into this remote and rarely visited wilderness. We will aim to come ashore at sites which showcase the majesty of the Antarctic environment and ecosystem, as well as exploring on Zodiac cruises. Embrace the wonder of this journey into the unknown, exploring a region few have had the privilege to witness.

## DAY 7-8 THE ANTARCTIC PENINSULA

In the days ahead, we venture further west along the Antarctic Peninsula into the Gerlache Strait region. This icy expanse requires meticulous planning by our Expedition Leader and Captain, who will plot a route to explore a variety of sites highlighting the area's staggering natural beauty.

The Gerlache Strait, consisting of the 'spine' of the Antarctic Peninsula and a large number of mountainous glaciated islands, offers a plethora of iconic Antarctic experiences. From Zodiac cruises in Paradise Bay, to witnessing penguins nesting on Cuverville Island, each potential stop promises awe-inspiring encounters. Explore historic huts at Damoy Point, witness humpback whales in Wilhelmina Bay, and marvel at the jaw-dropping scenery of the Lemaire Channel. Wherever we go on the Antarctic Peninsula, endemic wildlife, tantalising history and breathtaking natural beauty abound.

While our exact destinations will depend on weather and ice conditions, your Expedition Leader will ensure guests are informed of our plans through nightly briefings. In the ever-changing Antarctic environment, flexibility is key as we adapt plans to suit the conditions while offering enriching onboard experiences such as lectures, recaps, wine-tasting, and spa treatments.

## DAY 9 THE SOUTH SHETLAND ISLANDS

Our Antarctic odyssey culminates amidst the rugged beauty of the South Shetland Islands. This archipelago represents the northernmost tip of Antarctica, standing proud against the relentless force of the Southern Ocean. Despite the furious elements, the islands boast a remarkable richness of wildlife, with numerous colonies of Gentoo and Chinstrap Penguins dotting the island shores, accompanied by an array of formidable seabirds like the predatory Giant Petrels.

The ice-capped peaks of Livingstone, Greenwich, and King George Islands offer a stunning backdrop to explore. Experience the eerie landscape of Deception Island, an active volcanic crater with black steaming sands and rusting ruins, or witness the bustling penguin colonies on Aitcho and Half Moon Islands, or immerse yourself in the history of Yankee Harbour, once a vital anchorage for sealers.

As we bid farewell to the South Shetland Islands, we carry with us memories of their stark beauty and abundant wildlife, a fitting conclusion to our extraordinary Antarctic expedition.

## DAY 10-11 AT SEA - CROSSING THE DRAKE PASSAGE NORTHBOUND

We eventually depart Antarctica, and spend two days at sea on our way northwards back across the infamous Drake Passage, heading towards the more welcoming shores of the Beagle Channel and Ushuaia, Argentina. During our time at sea, a variety of activities will be arranged on board to provide our guests with the chance to reflect on their voyage. Relax with an expertly crafted cocktail in the Nordic Bar in the company of new friends, soak up the knowledge and passion of our Expedition Team during lectures in the Shackleton Lounge, or simply enjoy the flight of the albatross which accompany us northwards.

During your last evening onboard, join the Captain and Officers for the Farewell Cocktail Party, followed by a presentation of photos and video by our onboard photographer - the ideal opportunity to re-live your Antarctic adventure. Skål!

## DAY 12 ARRIVAL IN USHUAIA, DISEMBARKATION



Wild Earth Travel

*Small Ships, Big Adventures*

0800 945 3327 (within New Zealand) | +64 (0) 3 365 1355 | 1800 107 715 (within Australia)

[info@wildearth-travel.com](mailto:info@wildearth-travel.com) | [wildearth-travel.com](http://wildearth-travel.com)



# Wild Earth Travel

*Small Ships, Big Adventures*



[wildearth-travel.com](http://wildearth-travel.com)

[info@wildearth-travel.com](mailto:info@wildearth-travel.com)

On the morning of the final day of our voyage, we will arrive back at the pier of Ushuaia, Argentina. Trees, grass and a bustling city may seem strange to you after the white wilderness of Antarctica! After a hearty breakfast, it is time to bid a fond farewell to the Crew and Albatros Expedition Team, and descend the gangway back to dry land with memories of the voyage of a lifetime.

Please note:

Itineraries are subject to change.



Wild Earth Travel

*Small Ships, Big Adventures*

0800 945 3327 (within New Zealand) | +64 (0) 3 365 1355 | 1800 107 715 (within Australia)

[info@wildearth-travel.com](mailto:info@wildearth-travel.com) | [wildearth-travel.com](http://wildearth-travel.com)



# Wild Earth Travel

*Small Ships, Big Adventures*



[wildearth-travel.com](http://wildearth-travel.com)

[info@wildearth-travel.com](mailto:info@wildearth-travel.com)

## YOUR SHIP: OCEAN ALBATROS

<b>YOUR SHIP:</b>	<b>Ocean Albatros</b>
<b>VESSEL TYPE:</b>	<b>Luxury Expedition</b>
<b>LENGTH:</b>	<b>104.4 m</b>
<b>PASSENGER CAPACITY:</b>	<b>169 (95 cabins)</b>
<b>BUILT/REFURBISHED:</b>	<b>2022</b>

The Ocean Albatros, sistership to the Ocean Victory, will join the fleet of Albatros Expeditions in November 2022.

The Ocean Albatros will be deployed to a large selection of expedition cruise destinations, Antarctica, the Arctic, any various exciting new destinations in between.

With a total of 95 comfortable staterooms and suites, all with unobstructed sea view, most with their own balcony, the Ocean Albatros will definitely become one of the most popular expedition cruise vessels in the world. Like its sistership the Ocean Victory it offers two restaurants, a wellness area, an Albatros Nordic Bar, an open deck dining facility, a modern lecture lounge, and other state-of-the-art amenities. The vessel will have more than a 50% lower carbon footprint than traditional expedition vessels and be one of the most environmentally friendly, implementing the Green Initiative Program, ensuring both absolute comfort and sustainability for our guests. Unlike the Ocean Victory, the Ocean Albatros will also offer a unique panorama sauna, and a total of 12 dedicated solo travel cabins without a single-supplement.

### BRIDGE

Due to its important role as a control center for all nautical and

technical processes, the ship's bridge is a vital, sensitive place. Therefore, the bridge may not be accessible to the public at all times. Conditions permitting, we will be happy to welcome you into the bridge for a visit. Guests must be accompanied by the master or our expedition leader.

### STATEROOM SERVICE

Your stateroom is serviced daily. We provide a turn-down service. We provide meal to room only for serious cases of guest being sick. Our suites will have VIP services.

### ZODIAC LANDINGS

One feature of our expedition cruises includes landings and excursions aboard Ocean Albatros's fleet of 18 inflatable, motorized rubber "Zodiac" boats. The Zodiac brand has earned a well-deserved reputation as the sturdiest and safest small watercraft available. These boats have a low draft and great stability. Zodiacs are constructed for professional use and are outfitted with a top-quality outboard engine, yet their design minimally impacts the environment.

The Zodiacs are designed to provide unrestricted access to the world's last great frontier. Their versatility enables us to make landfall on remote shores, cruise along awe-inspiring coastlines and share breathtakingly close encounters with whales, seals, penguins, seabirds and more. We will come within arm's reach of icebergs and set foot on land discovered by pioneering explorers just over a century ago.

Your safety and comfort are our #1 priority, and your expedition leader will carefully plan for as many Zodiac excursions as possible, dependent upon the local weather and prevailing conditions. In each case, the expedition leader makes the final



Wild Earth Travel

*Small Ships, Big Adventures*

0800 945 3327 (within New Zealand) | +64 (0) 3 365 1355 | 1800 107 715 (within Australia)

[info@wildearth-travel.com](mailto:info@wildearth-travel.com) | [wildearth-travel.com](http://wildearth-travel.com)



# Wild Earth Travel

*Small Ships, Big Adventures*



**wildearth-travel.com**

**info@wildearth-travel.com**

decision if the landing is possible or not. Safety regulations apply on landings. All guests receive a mandatory instruction of the safety guidelines. Life jackets are mandatory to wear.

Please note, we highly recommend the use of waterproof bags in order to protect your personal camera or binoculars, as both hands must be free of everything during boarding. Participation is fairly easy and comfortable for able-bodied guests but can be more challenging for those with physical handicaps.

#### GRATUITIES

Following international standards in the service industry, it is customary to leave gratuity for the ship's crew at the end of the voyage. All gratuities will be divided among the crew. Typically, a recommended amount is approximately 13.5 USD per person per day. Gratuity is, of course, not required and any gratuity payments are voluntary.

#### DRESS CODE

The dress code on board is casual. Ties, jackets and evening dresses you may leave at home. It is rather more important to wear the right clothes in order to adapt to the different weather conditions. We recommend comfortable, breathable, waterproof and windproof clothing. Also, you should have a pair of gloves, thermal underwear and sturdy footwear in your luggage. For the captains and farewell cocktail, we recommend a smart casual dress style.

#### INTERNET / PHONE

Keep in mind, we will be cruising in a very remote region of the world. Where accessible, internet access is available for an extra charge. Mobile phone reception may be possible in select regions along our route. For further details please contact your mobile phone operator. Prices can be found in the information folder in your state room. Please ensure that your 'Data Roaming' function is switched off.

#### RECEPTION

The daily office hours of the board reception are from 06:00 until 23:00.

#### ALBATROS OCEAN SHOP

The selection of items available for purchase varies by ship, and may include a range of warm and practical clothing, as well as souvenirs, local arts and postcards at reasonable prices. A small selection of soap, toothpaste and other personal effects are also sold.

#### HEALTH / MEDICAL EMERGENCY

Each of our vessels has a small medical facility equipped with the necessary equipment and medicine to handle small emergencies. The infirmary is always staffed by a professionally licensed, English-speaking physician and nurse. Should a serious incident occur, the nearest hospital will be contacted. All guests must have personal travel/health insurance.

Although we do not have an official requirement regarding personal fitness, you should be able to move on board and ashore without the help of others. Please be aware that the ship does not provide wheelchair accessible state rooms.

Due to safety reasons a cruise is only possible for pregnant women until the 24th week of pregnancy. The state of pregnancy must be presented by a medical certificate.

#### PHYSICAL DISABILITIES / WHEELCHAIR ACCESSIBILITY

Guests with physical disabilities are recommended to travel with an accompanying person. The processes on board should be handled without external help. The gangway can be - depending on the individual disability - a challenge. The angle of inclination of the gangway varies due to tide and different circumstances in the respective port. Please note that the guest's participation in shore excursions as well as the (dis-)embarkation by Zodiac can

Wild Earth Travel

*Small Ships, Big Adventures*

**0800 945 3327** (within New Zealand) | +64 (0) 3 365 1355 | **1800 107 715** (within Australia)

info@wildearth-travel.com | **wildearth-travel.com**

# Wild Earth Travel

*Small Ships, Big Adventures*



[wildearth-travel.com](http://wildearth-travel.com)

[info@wildearth-travel.com](mailto:info@wildearth-travel.com)

be denied by the expedition leader due to security reasons. The instructions of the expedition leader must be followed. The ship is not suitable for wheelchairs.

#### SEASICKNESS / STABILISATORS

The ship is equipped with stabilizers in order to reduce the ship's roll. However, these expeditions are hosted in remote regions, and it is possible to periodically encounter changing environments and climate patterns, including rough seas and large swells. Seasickness patches (Scopoderm or similar) work solely or in part to help cure nausea for most people. These medicines can cause sleepiness. If you are prone to motion sickness, consult with your doctor prior to departure to help ensure your comfort while travelling.

#### SPECIAL DIETARY REQUESTS

All meals on board the vessel is chef-prepared. If you have special dietary requirements (food allergies, intolerances, health conditions or religious preferences), please inform us as early as possible - ideally, no later than 2 weeks before departure. In order to ensure efficient service, please re-confirm your requirements with the crew upon boarding the ship.

#### LAUNDRY

If you wish to have some laundry done while aboard the ship, laundry service is available for an additional fee.

tional fee.



Wild Earth Travel

*Small Ships, Big Adventures*

0800 945 3327 (within New Zealand) | +64 (0) 3 365 1355 | 1800 107 715 (within Australia)

[info@wildearth-travel.com](mailto:info@wildearth-travel.com) | [wildearth-travel.com](http://wildearth-travel.com)



wildeath-travel.com

info@wildeath-travel.com

## INSIDE YOUR SHIP

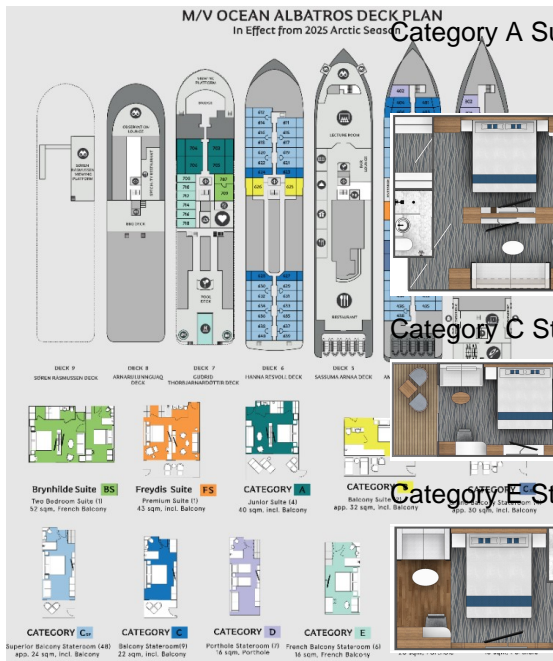

Category A Suite - Junior Suite

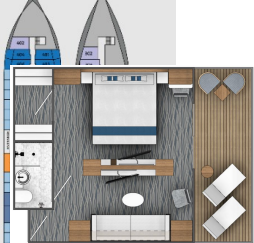

Category C Stateroom - Balcony Stateroom



Category E Stateroom - French Balcony Stateroom



Category G Stateroom - Single Stateroom (Porthole)



Category B Suite - Balcony Suite



Category D Stateroom - Albatros Stateroom



Category F Stateroom - Triple Stateroom



Family Suite - Brynhilde Suite





# Wild Earth Travel

*Small Ships, Big Adventures*



[wildearth-travel.com](http://wildearth-travel.com)

[info@wildearth-travel.com](mailto:info@wildearth-travel.com)

## PRICING

08-Nov-2025 to 19-Nov-2025

Category F Stateroom - Triple Stateroom (Porthole)	10995 USD pp
Category D Stateroom - Albatros Stateroom (Porthole)	12895 USD pp
Category E Stateroom - French Balcony Stateroom	13595 USD pp
Category C Stateroom - Balcony Stateroom	13995 USD pp
Category G Stateroom - Single Stateroom (Porthole)	16195 USD pp
Category B Suite - Balcony Suite	18395 USD pp
Category A Suite - Junior Suite	23495 USD pp
Family Suite - Brynhilde Suite	26395 USD pp
Premium Suite - Freydis Suite	26395 USD pp

### Optional extras & upgrades

Kayaking 345 USD

Snowshoeing 225 USD

Camping 395 USD

Photography 495 USD

Wild Earth Travel  
*Small Ships, Big Adventures*

0800 945 3327 (within New Zealand) | +64 (0) 3 365 1355 | 1800 107 715 (within Australia)

[info@wildearth-travel.com](mailto:info@wildearth-travel.com) | [wildearth-travel.com](http://wildearth-travel.com)